

GAS CAPSULE 350V 10KA

R445.999.101

Series : **GDT**

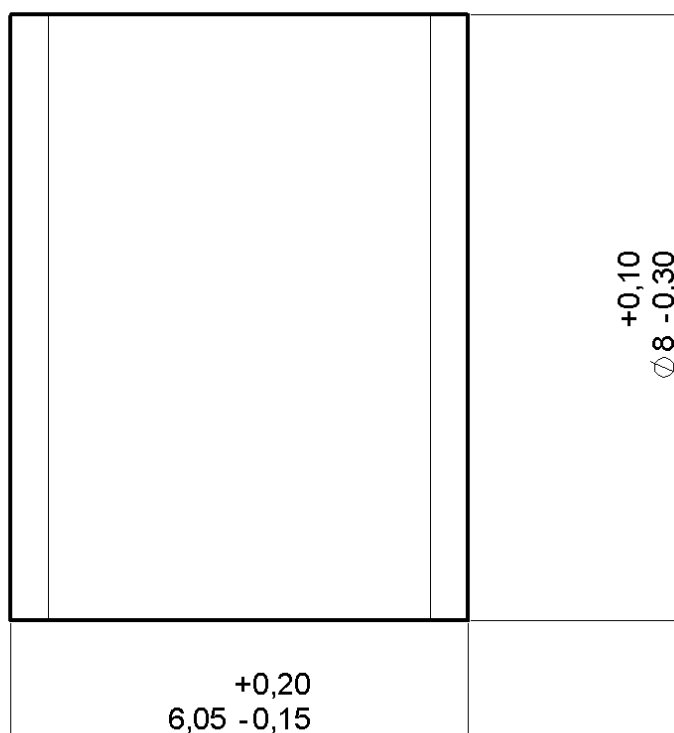

All dimensions are in mm.



COMPONENTS	MATERIALS	PLATINGS (μm)
ELECTRODES	METAL	
INSULATOR	CERAMIC	
-		
-		
-		
-		
-		
-		

Issue : 1002 A

In the effort to improve our products, we reserve the right to make changes judged to be necessary.



GAS CAPSULE 350V 10KA

R445.999.101

Series : **GDT**

PACKAGING

Standard	Unit	Other
1		Contact us

ELECTRICAL CHARACTERISTICS

Nominal DC spark-over voltage : **350V +/- 20%**

Impulse spark-over voltage at 1 kV/μs : **< 800V**

Nominal impulse discharge current (wave 8/20μs) : **10 kA**

Nominal alternating discharge current (50Hz, 1s) : **10 A**

Insulation resistance : **10¹⁰ Ohm at 100 V**

Capacitance : **< 1.5 pF**

MECHANICAL CHARACTERISTICS

Weight **1.500 g**

ENVIRONMENTAL

Operating temperature : **-40 / 100 °C**

Storage temperature : **-40 / 100 °C**

Relative humidity :

Climatic category (IEC 68-1) : **40/100/21**

Issue : 1002 A

In the effort to improve our products, we reserve the right to make changes judged to be necessary.

